

NO	QTY	PART NO	DESCRIPTION	REPAIR KIT
1	1	21440022	SHSS, CUP POINT	
2	1	23350015	SPRING, COMPRESSION	
3	1	27742401	CORDSET, MALE, FEMALE, M8, .6M, SHIELDED	
4	1	31091006	FILTER, BRONZE, SINTERED, .250, 150μ	
5	1	39000070	O-RING, (-904)	X
6	1	39050026	O-RING, (-018)	X
7	1	39050052	SEAL, PIN, STROKE, SWITCH, PRESS	
8	1	39050053	O-RING, (-002)	
9	1	39051075	O-RING, (24.5mm x 1.5)	
10	1	39053003	WIPER, PRESS-IN, (1)	
11	1	87075001	SHIM, ENDED, DOUBLE	
12	1	87075002	BODY, SWITCH, PRESSURE	
13	1	87075003	PLUNGER, SWITCH, PRESSURE	
14	1	87075006	PIN, STROKE, SWITCH, PRESSURE	
15	1	87075007	COLLAR, SWITCH, PRESSURE	
16	1	87075010	ADJUSTER, SWITCH, PRESSURE, SEVERE	
17	1	97075005	ASSY, SWITCH, PRESS, M8	X
N/A	N/A	62707003	KIT, REPAIR, SWITCH, PRESS	NOTED

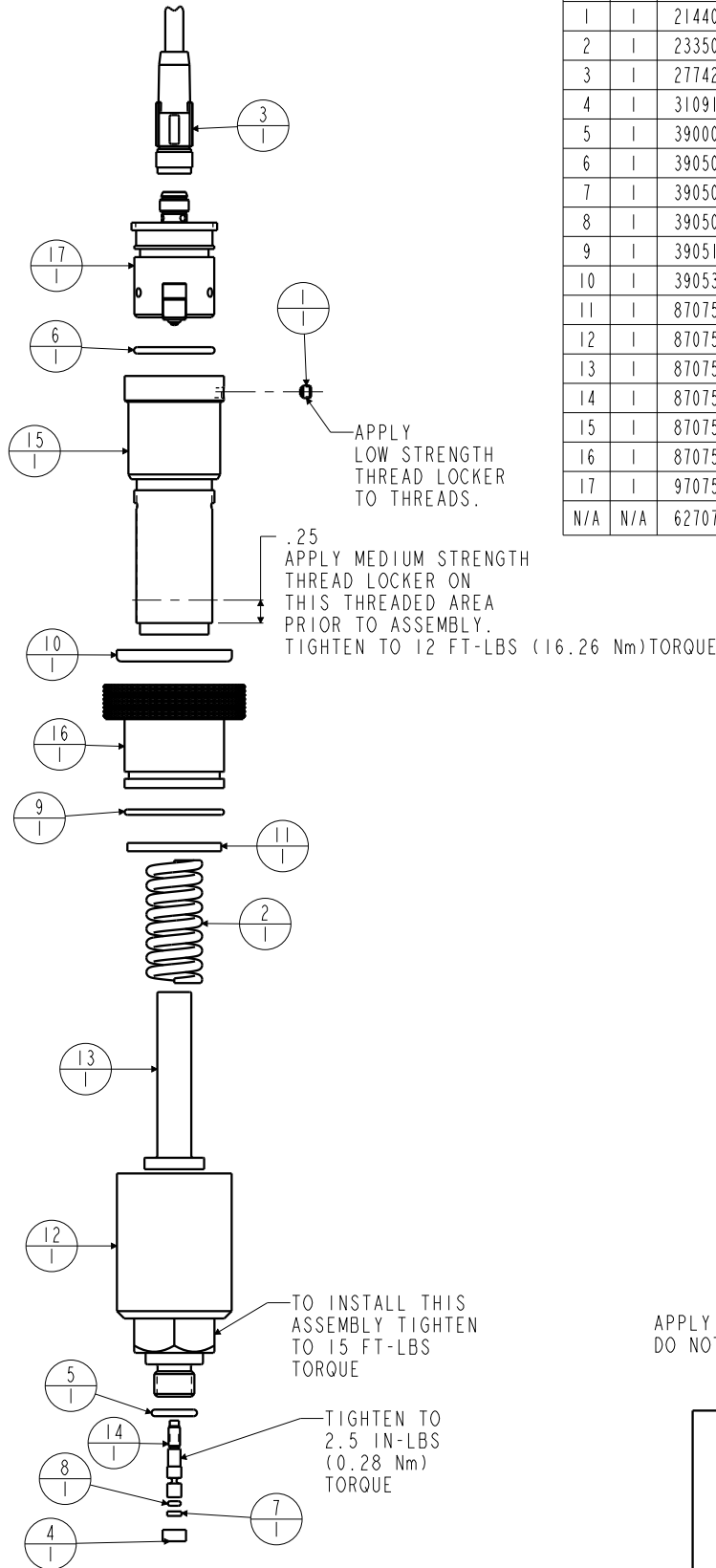

APPLY LUBRICANT TO ALL SEALS PRIOR TO INSTALLATION  
DO NOT USE SILICONE TYPE LUBRICANTS.

### PARTS LIST



VEKTEK, INC.  
1334 E. SIXTH AVE. P.O. BOX 625  
EMPORIA, KS. 66801 U.S.A.

ASSEMBLIES AFFECTED  
70750078

SIZE  
A PL7125

REV  
B

B	5303	RELEASE	JDW	05/01/24
REV	IN ACCORDANCE WITH ECN	EFFECTIVE DATE	REVISED BY	DATE
DRW BY:	KR	DRAWING STATUS: <b>Released</b>		
DATE:	07/12/17	PRODUCTION APPROVED FOR RELEASED STATUS ONLY		